



Series 810

Frameless Swing Door with Continuous Hinge Installation Instructions

Illustration of Parts Breakdown

Set Contents

N0.	QTY	Description
①	2	U-wall jamb (S116)
②	1	Assembled Door (800 series)
③	1	Strike Jamb (S119) w/ magnet (SDMAGNET,SDPLATE) and vinyl (CO-EXT BULB SEAL CLR)
④	1	Drip rail (SX1097CLR)
⑤	1	C-handle (CHANDLE)
⑥	6	8 x 1" pph screws (2-236)
⑦	6	6-20 x 1/2" pph tek screws (2-323)
⑧	6	Plastic wall anchors (2-477)
⑨	1	Magnet Strike Plate w/ Gasket (SF205, SDMAGNET,SDPLATE)

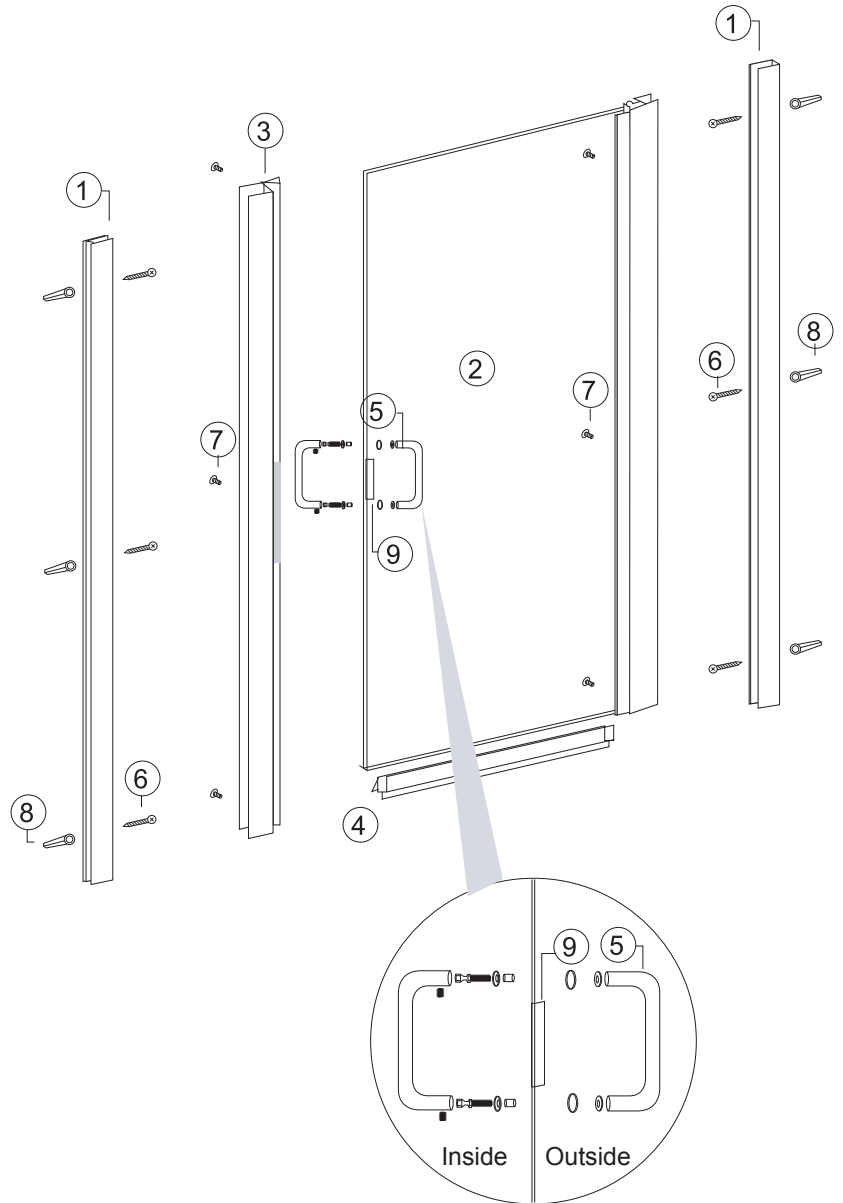

CAUTION:
Tempered Glass cannot be cut or drilled.

IMPORTANT: Before beginning installation, read instructions thoroughly and carefully. Always protect your eyes with safety goggles.

TOOLS REQUIRED FOR INSTALLATION

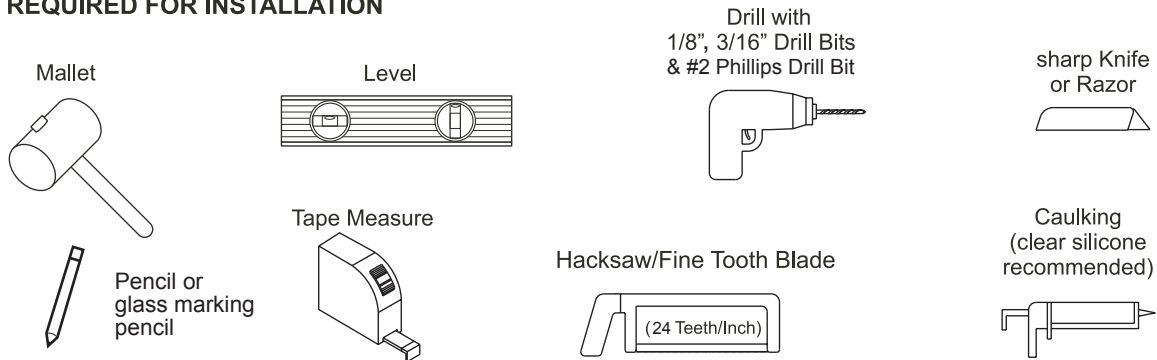

STEP 1

From outside edge of shower sill, measure to desired location for shower enclosure. Mark with pencil both sides evenly making sure both marks are equal in distance from outside edge of shower sill. These two marks will be the outside edge of your wall jamb (1).

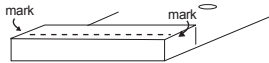

STEP 2

Using a level, position the wall jambs (1) lining bottom outside edge with marks you made with pencil and against the walls with the longer legs toward the opening. Mark through the holes provided for anchoring. Drill 3/16" holes and insert plastic anchors (8) for masonry applications or drill 1/8" tap holes for fiberglass and acrylic units. Secure jambs (1) to the walls with #8 x 1" screws (6).

STEP 3

Determine which side you would like the door to hinge from. Generally hinge off the wall with the plumbing, making sure the door has 90° of clearance. Position the door assembly (2) into the opening. Plumb the door assembly (2) and secure it to the wall jamb (1) using #6 x 1/2" Tek screws (7). Leave a minimum of 1/2" even reveal between door (2) and wall jamb (1) top to bottom.

STEP 4

Position the strike jamb (3) onto wall jamb (1) and plumb to the door panel. Do not secure at this time.

STEP 5

With door assembly (2) closed, locate magnet on strike jamb (3) and mark location outside of glass with pencil. Open door assembly (2) and center gasket, then magnet plate (9) over marked location and tap on with rubber mallet. Close door to check alignment of the magnet plate (9) on the door with magnet in strike jamb (3).

STEP 6

Once aligned, secure strike jamb (3) to wall jamb (1) using #6 x 1/2" tek screws (7). Attach C-handle (5) in existing holes provided in glass.

STEP 7

Notch drip rail (4) so that flange and drip rail cover the full width of door including hinge. Run a small bead of silicone inside of U-shaped drip rail (4), then press upwards onto bottom of door by hand. Adjust so that drip rail (4) drags along top shower stall sill.

STEP 8

Caulk all edges and joints exposed to water, using a silicone based caulk or other suitable sealant that will prevent water leakage.